



## DEAD AND ADJUSTABLE LATCH BOLT



### CONSTRUCTIVE FEATURES:

Zinc and plastic plated steel case and cover - Stainless steel forend  
 - Nickel-plated special alloy dead bolt - Nickel-plated special alloy anti-noise latch bolt - Zinc-plated special alloy square spindle device  $\varnothing 8$  mm.

### WORKING:

Key driven dead bolt - Handle or key driven latch bolt.

### HAND:

Reversible.

### PROVIDED WITH:

Cylinder screw.

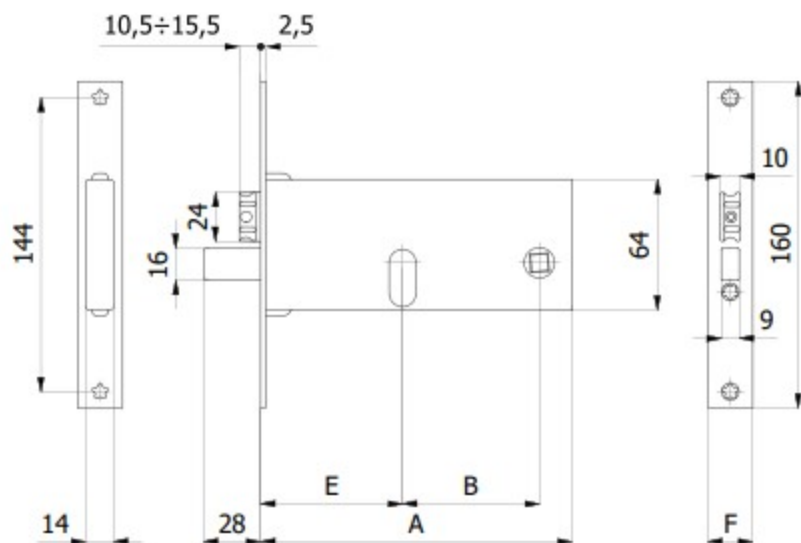

COD.	E	F	A	B	Throws	kg		
782	70	16	153	67	3	0,53	1	10
782/F22	70	22	153	67	3	0,55	1	10
782-TT/F15	70	14,6	153	67	3	0,54	1	10
882	80	16	163	67	3	0,56	1	10
882/F22	80	22	163	67	3	0,58	1	10
882-TT/F15	80	14,6	163	67	3	0,57	1	10